

MerrittView Conference Center

The Conference Center is located on the 1st floor and includes the following:

- A maximum capacity of up to **18 persons**, following social distancing guidelines.
- Three (3) different layout options which allow for the required social distancing.
- High performance air filtration (MERV-13)
- AtmosAir bipolar ionization air purification system
- Enhanced cleaning (green whenever possible and proven CDC approved disinfection for COVID-19).
- High Speed Wi-Fi.
- Full pantry with sink, refrigerator, and shelving for catering needs.
- Moveable podium for speaking engagements.
- Presentation board and markers for use in training sessions.
- Projector and screen setup available.
- Catering available upon request. Please contact merrittviewgrille@cidining.com for more information.

The Conference Center is available to all tenants and can be reserved up to 24 hours in advance via the Workspeed system. The conference rooms may be reserved in full day (8 hour) increments. The configuration/layout type should be included in the Workspeed reservation. Rates are as follows:

Conference Room

- Rates: \$425

All guests must be pre-registered via the Workspeed or via email to lhenson@empirestaterealtytrust.com.

All room rentals reservations must be canceled no less than one day in advance to avoid being charged the rental fee.

Should you have any questions please contact Lydia Henson at lhenson@empirestaterealtytrust.com.

Be Smart. Be Safe.

MERRITTVIEW

NORWALK, CT

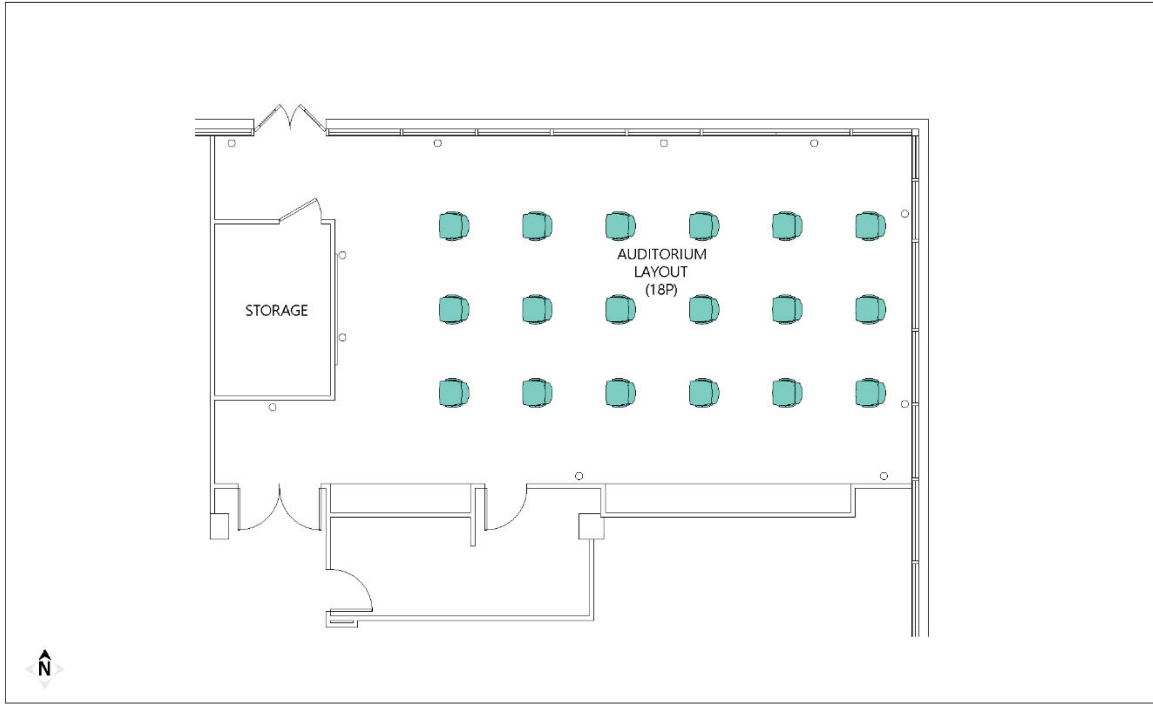

EMPIRE STATE
REALTY TRUST
empirestaterealtytrust.com

ESRT
LISTED
NYSE

MERRITTVIEW

NORWALK, CT

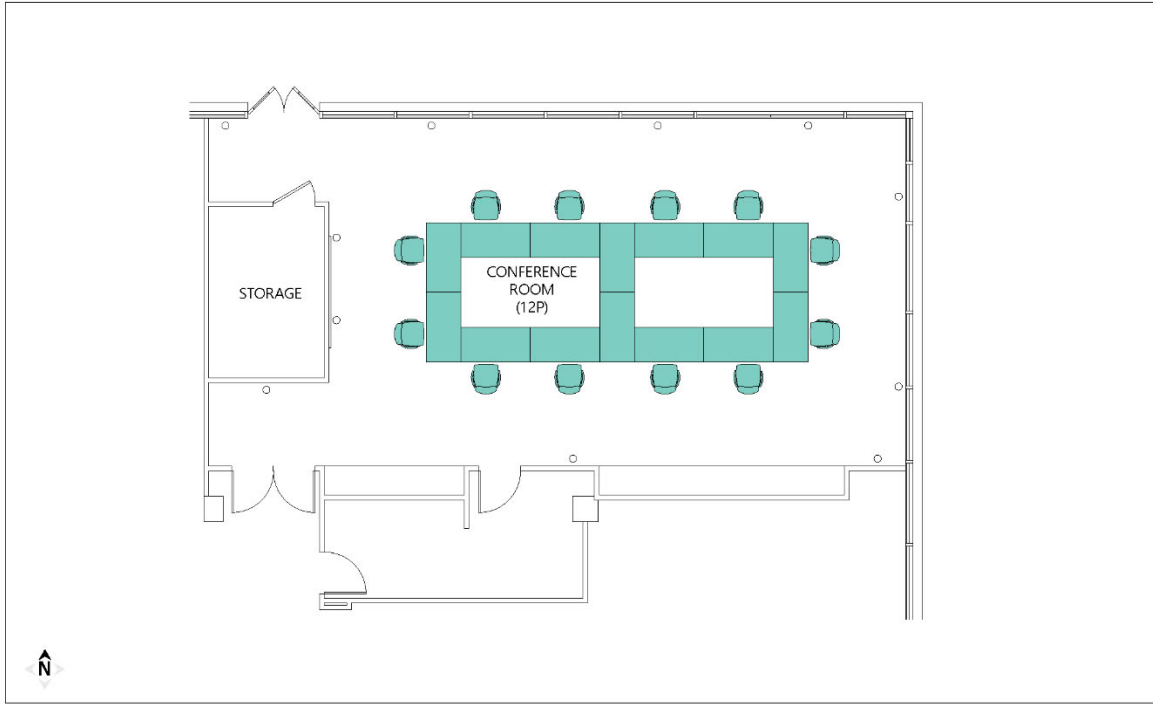

EMPIRE STATE
REALTY TRUST
empirestaterealtytrust.com

ESRT
LISTED
NYSE

EMPIRE STATE
REALTY TRUST

ESRT
LISTED
NYSE

MERRITTVIEW

NORWALK, CT

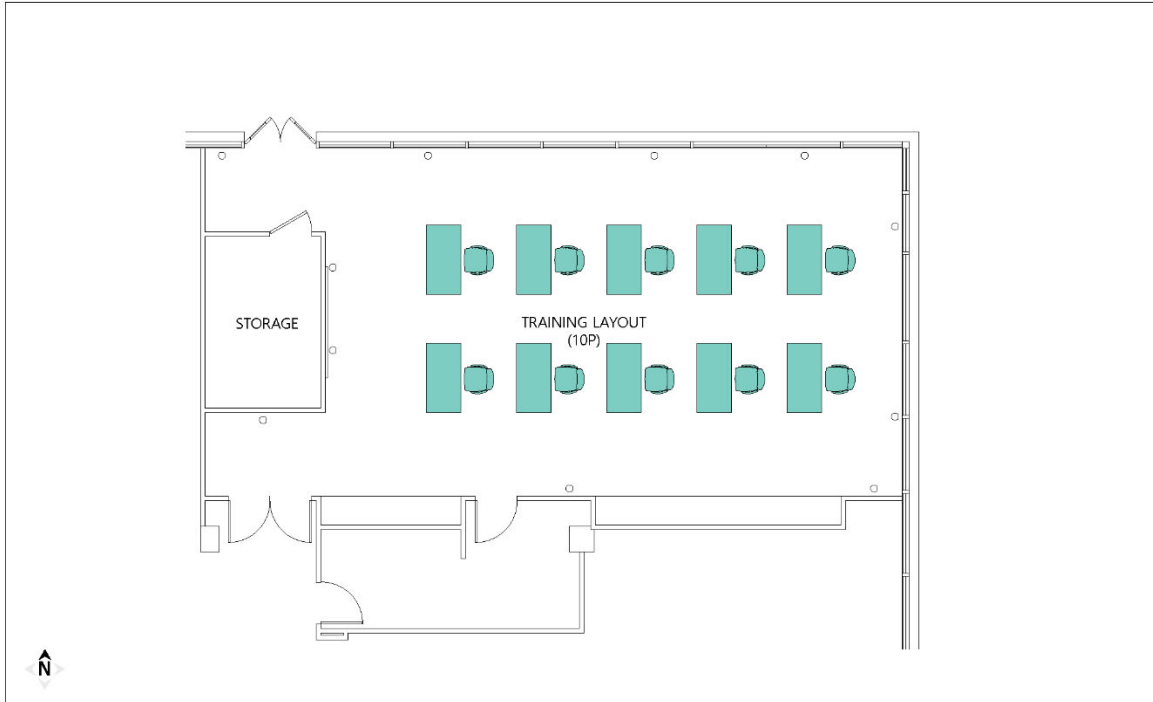

EMPIRE STATE
REALTY TRUST
empirestaterealtytrust.com

ESRT
LISTED
NYSE

EMPIRE STATE
REALTY TRUST

ESRT
LISTED
NYSE